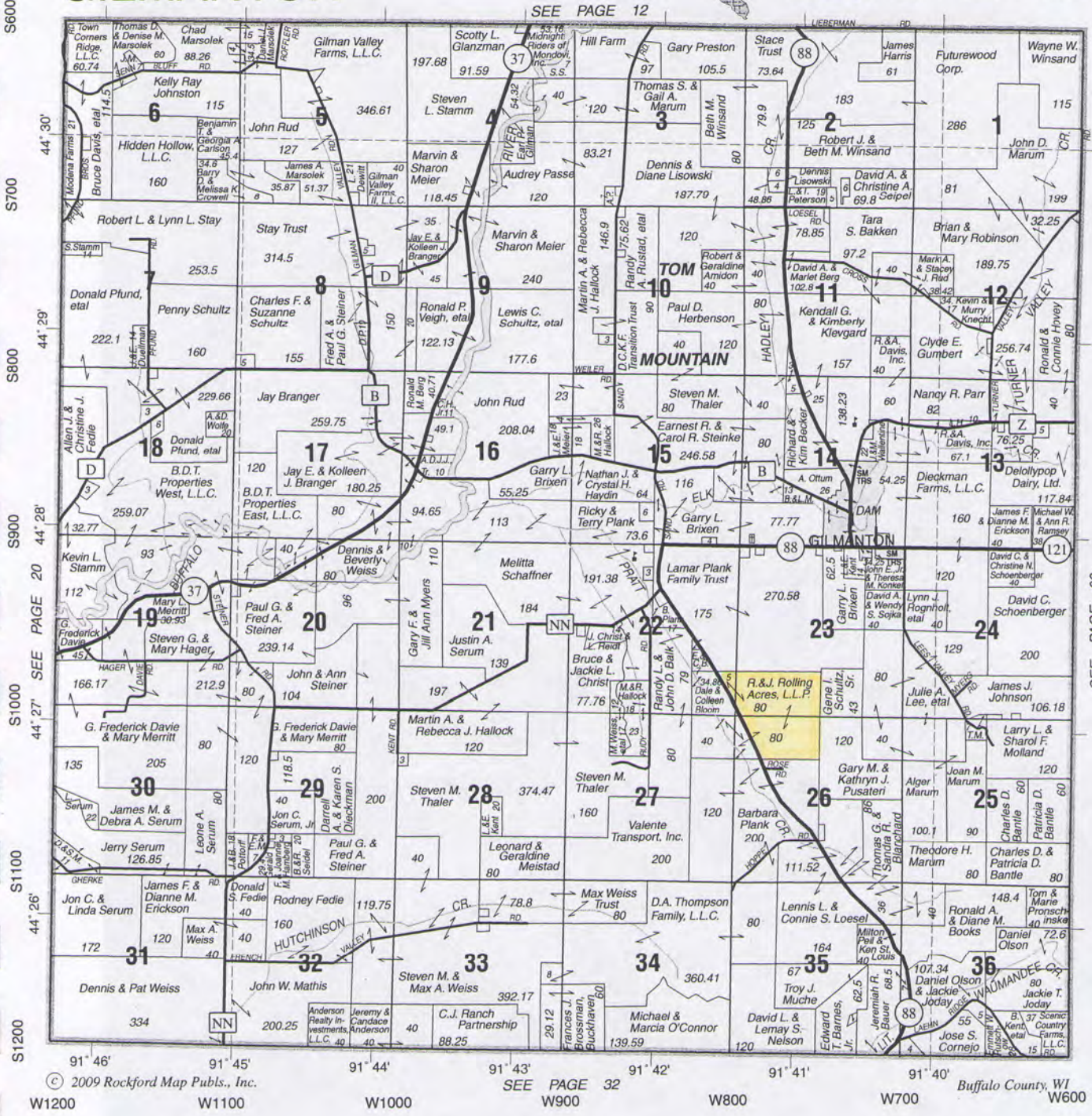

Exhibit C - Plat Map

GILMANTON

T.23N.-R.11W.



SEE PAGE 12

SEE PAGE 32

SEE PAGE 26



Creative Solutions...Exceptional Value
1-800-236-7585
 Visit us at: www.countrysidecoop.com
 E-Mail: info@countrysidecoop.com



MONDOVI: 715-926-4265 **ARCADIA: 608-323-3330**
INDEPENDENCE: 715-985-3191

Your Hometown Real Estate Company!
www.northerninvestment.com
 • REAL ESTATE
 • APPRAISALS
 • AUCTIONS



0 ————— 0.2 Mi
0 ————— 1000 Ft

Exhibit E
Plant/Mine Location